

Introduction of T-Series

- Design team of RD -

May 7th, 2015

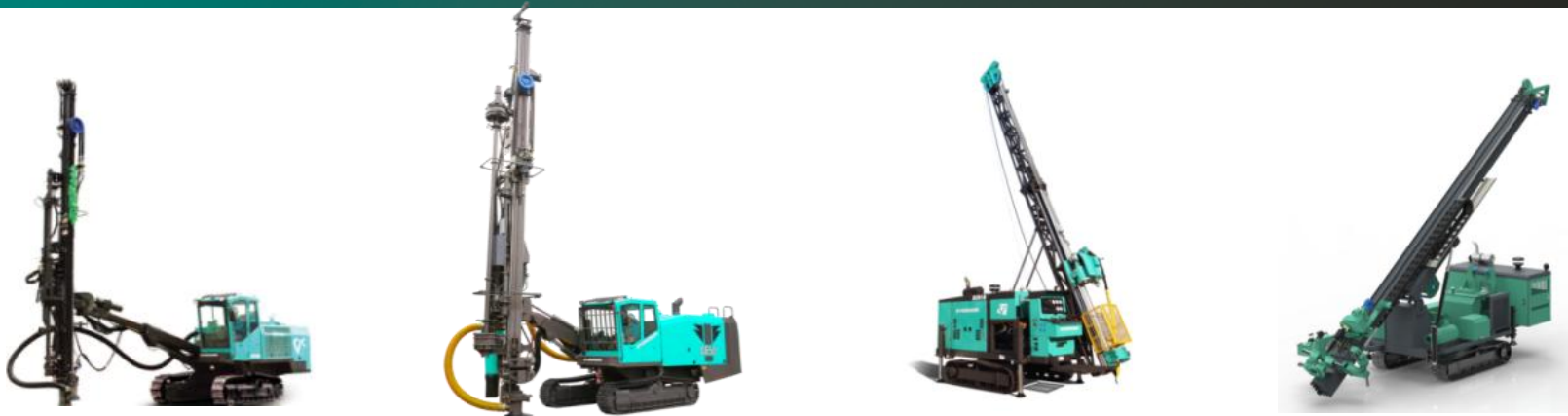

THD – T Series

▣ Main features

The image shows a large tracked drilling rig, the THD – T Series, with several callouts pointing to specific features. The rig is primarily teal with black tracks and yellow safety railings. Callouts include:

- Magazine type rod handling system (pointing to the vertical rod assembly on the left)
- Improved safety devices (pointing to the lower part of the rod assembly)
- Comfort Control and monitoring system (pointing to the operator's cab area, with an inset image showing the interior)
- Options for operator convenience (pointing to the rear of the cab, with an inset image showing a control panel)
- Advanced maintenance access points (pointing to the side of the engine compartment)

THD – T Series

■ Safety

- Emergency shut down button switch

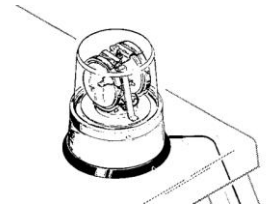

- Rotating beacon

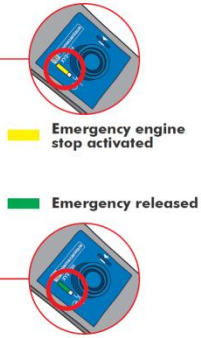

Emergency engine stop activated

Emergency released

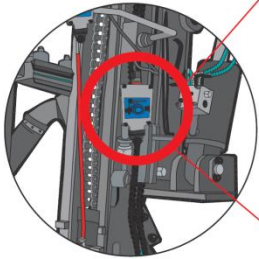

- Emergency shut down wire switch



- Rear view camera (Option)

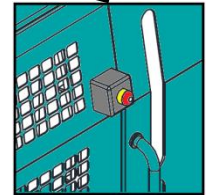

- Emergency shut down button switch



- Safety Guard (Option)

- Safety lever, Door sensor

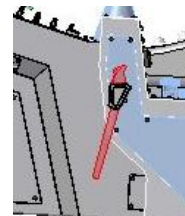

- Safety hammer

THD – T Series

▣ User Convenience Options

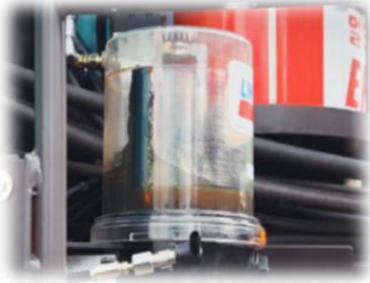

- Centralized grease pump
- Drill monitoring system



* MDS-1000

- Drilling Angle : (+60° ~ -60° , X, Y axis)
- Drilling Depth

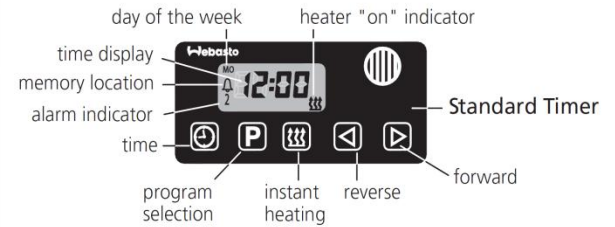

- Webasto coolant preheating system



* MDS-2000

- Drilling Angle : (+60° ~ -60° , X, Y axis)
- Drilling depth
- Engine monitoring (ECU engine only)
- Drill stop
- User data
- GPS
- Remote engine control (anti thief)

THD – T Series

▣ User Convenience Options



- Triple grouser track

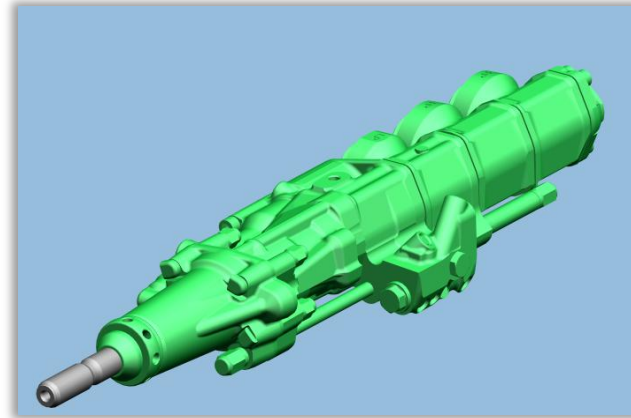

- Montabert drifter (HC150, T-450 only)



- Water injection system



- CAT engine (T-400, T-450)

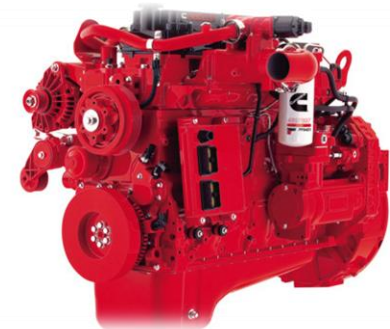

- Cummins Tier 3 engine

THD – T Series

▣ Cabin lay out for best operator comfort

- Wider front view
- Gauges location on the front

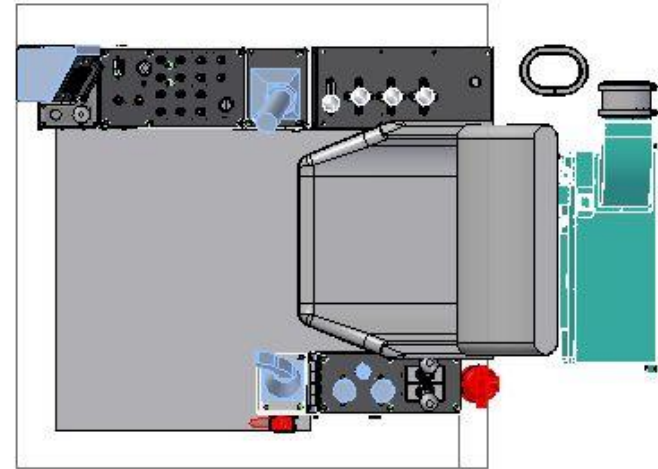
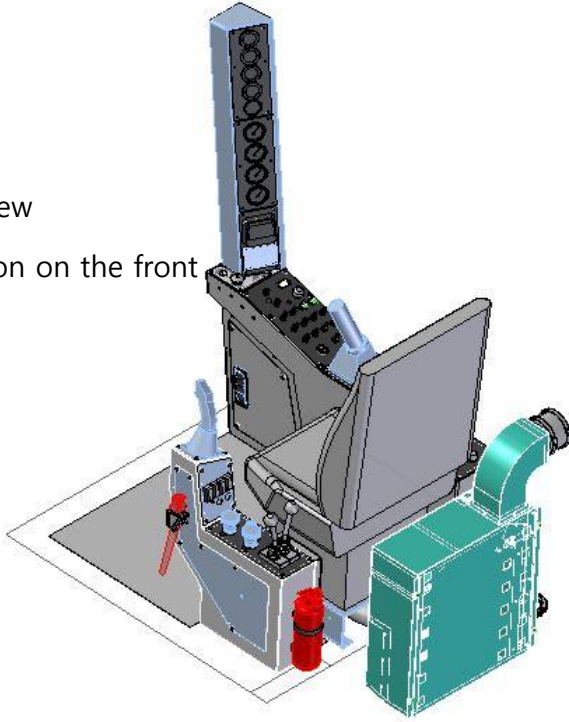

- Well arranged control panels

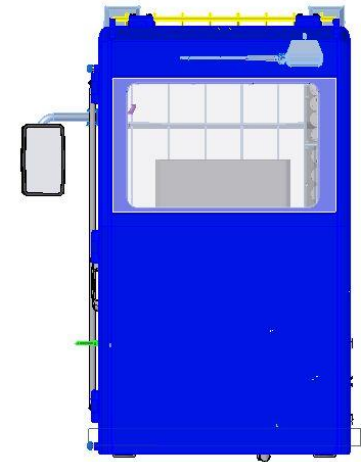
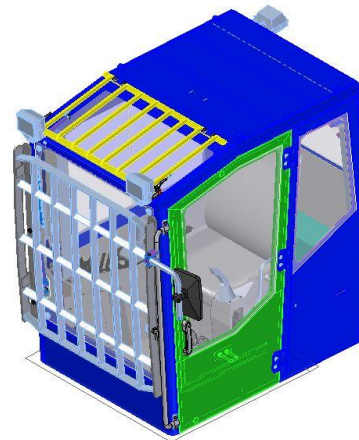

- Wide windows

THD – T Series

■ EHD Drifters with Optimal Performance

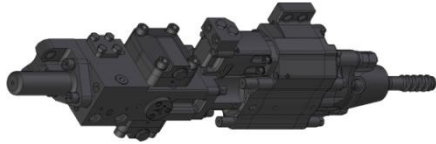

[EHD Series without RP]

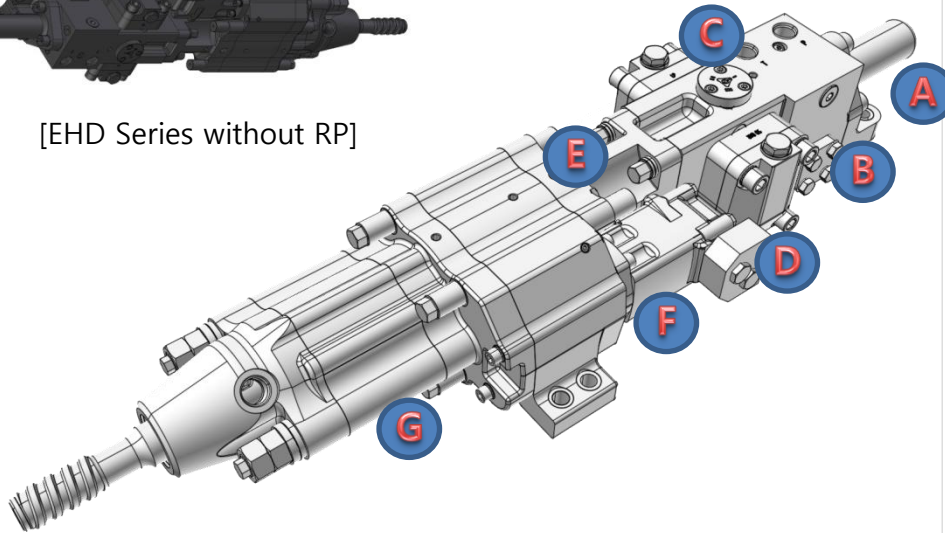

A : High piston stroke → Maximize impact power

B : Optimal valve design → High efficiency and performance

C : 3 stage percussion speed adjuster → Percussion power and speed can be adjust manually according to rock hardness

D : Accumulators → Optimized hydraulic condition with easy maintenance

E : Damping system → Increase durability and lifecycle of parts against severe working condition

F : High torque motor & needle bearing → Maximize rotation efficiency and performance

G : Reverse Percussion (Option) → Release rod and bit from stuck condition inside of ground

* Optional RP switch enables RP when jamming condition occurs during drilling.

Drifter Model	Sort	Standard	Reverse Percussion
EHD160	Weight (without Shank)	217 kg	236 kg
	Output power	16 KW	
	Rod (mm)	T38 (Ø76 ~ 89) / T45 (Ø89 ~ 102)	
EHD185	Weight (without Shank)	217 kg	236 kg
	Output power	18.5 KW	
	Rod (mm)	T38 (Ø76 ~ 89) / T45 (Ø89 ~ 102)	
EHD210	Weight (without Shank)	217 kg	236 kg
	Output power	21 KW	
	Rod (mm)	T45 (Ø89 ~ 102) / T51 (Ø102 ~ 127)	

Rod handling system (Rod Gripper + Magazine type)

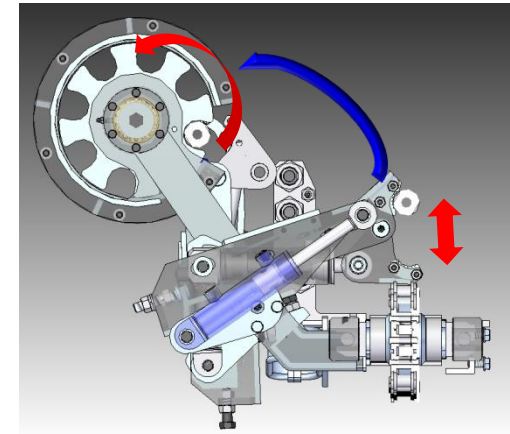
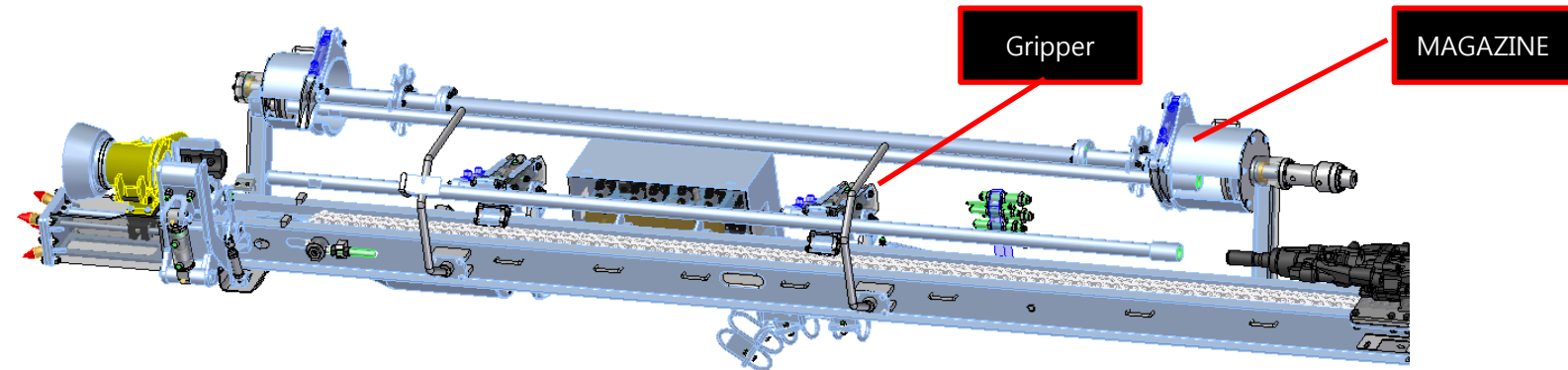

Feature

- Similar rod handling system of Atlas Copco drilling rig for operator convenience
- Manual, semi auto and full automatic rod changing operation is realized through precise sequence control

Rod handling system (Roller + Magazine type)

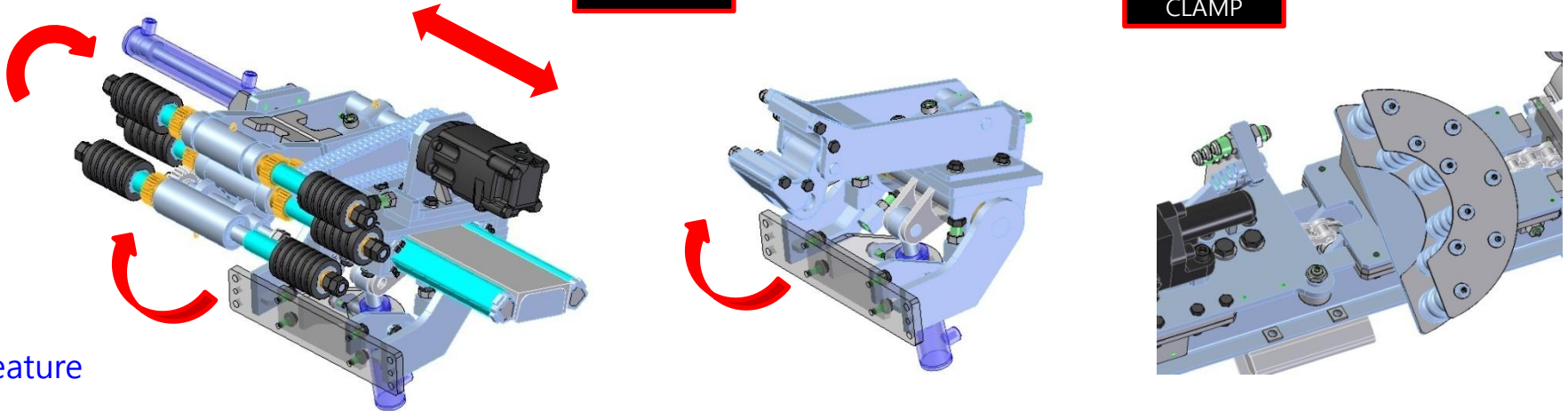
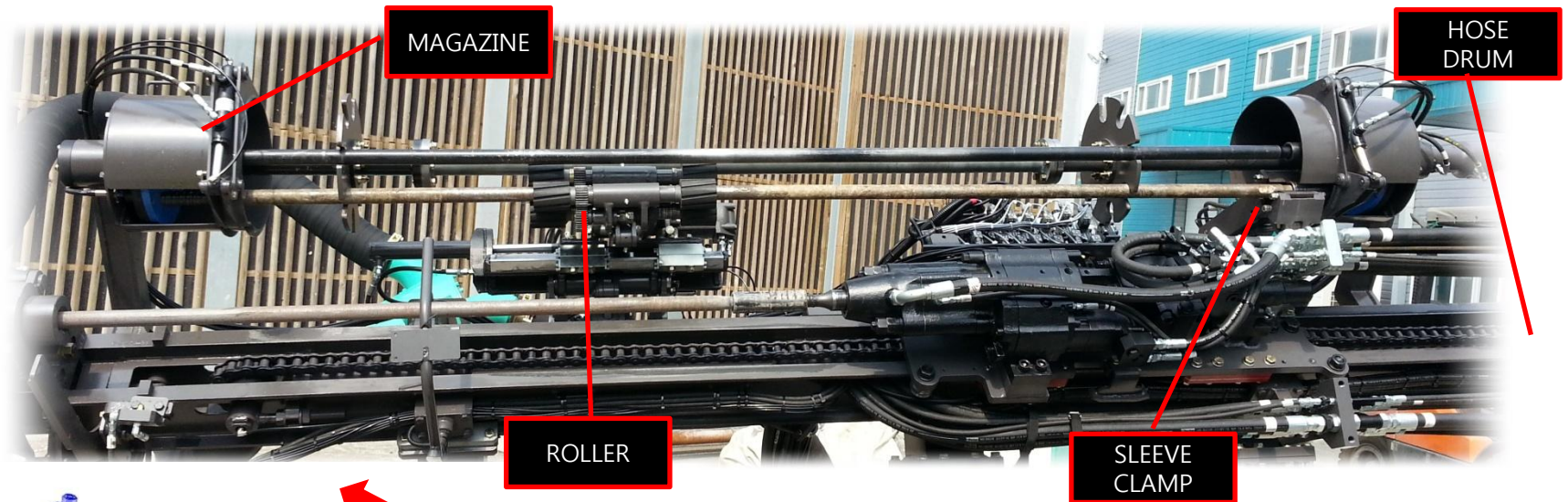

Feature

- Taking only benefits of roller type (Everdigm, Furukawa, Junjin) plus revolver type (Atlas Copco, Everdigm (T-series) rod handling systems
- Better structure for rod alignment and minimizing rod changing time.
- According to test, 10 seconds for rod adding. And 14 seconds for rod removing. This is much faster than Atlas copco revolver type.
- EX-Rod (coupling type) and MF rod can be installed on this type without modification.
(Separate gripper is required for Revolver type rod handling system)

